

Front Brakes

Repair Instructions

Front Brake Components

BENE31J14206001

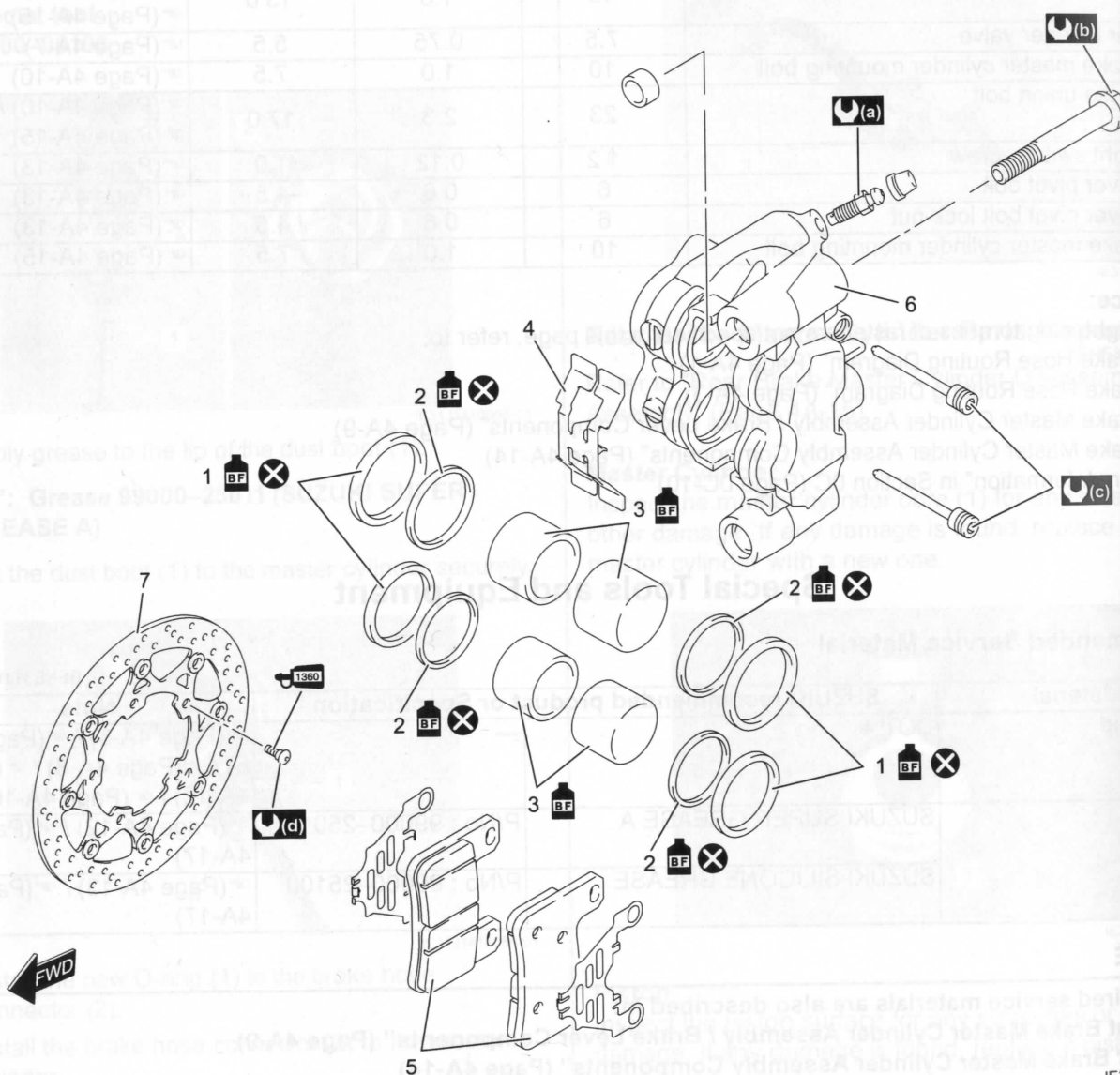

IE31J1420020-02

1. Piston seal	6. Front brake caliper	(d) : 23 N·m (2.3 kgf-m, 17.0 lbf-ft)
2. Dust seal	7. Front brake disc	1350 : Apply thread lock to the thread part.
3. Piston	(a) : 7.5 N·m (0.75 kgf-m, 5.5 lbf-ft)	BF : Apply brake fluid.
4. Brake pad spring	(b) : 39 N·m (3.9 kgf-m, 28.5 lbf-ft)	: Do not reuse.
5. Brake pad	(c) : 16 N·m (1.6 kgf-m, 11.5 lbf-ft)	